

**Pillar / stand
with position indicator**

**PN10
PN16**

WATER

SEWAGE

GAS

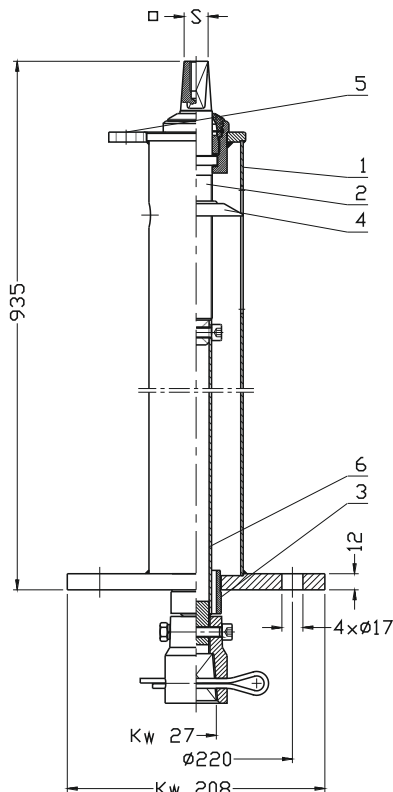

Application:

Water



Fire-fighting system



Gas



INDEKS	S	F	Turn for full open	Weight	Fitting samples			
					2111, 2002, 2311, 2312, 2314	2005, 2006	4493 gearbox	4496, 4497 gearbox Rotork
	[mm]	[Nm]		[kg]	diameter			
W-9113-064	19	350	64	12	DN40-DN300	DN50-DN150	DN200-DN600	DN40-DN800
W-9113-090	27	500	90	14	DN350-DN700	DN200-DN350	-	-
W-9113-250	27	500	250	17	DN800-DN1200	DN400-DN1000	DN700-DN1200	DN900-DN1200

No.	Part	Standard execution
1	Body	Stainless Steel 1,4301 EN 10027-2
2	Stem	Stainless Steel 1,4021 EN 10027-2
3	Centring bearing	PE 100 SDR 11 EN 1555
4	Indicator	Brass CW617N EN 1412
5	Protection lug	Stainless Steel 1,4301 EN 10027-2
6	Spindle	Stainless Steel 1,4301 EN 10027-2

Product description (standard execution):

- Fully monolithic body (base, stand pipe, cover) made of stainless steel
- Axial spindle with centring bearing
- Stem stainless steel ball bearing in the vertical and horizontal way
- Protection lug for locking device
- Mechanical position indicator

Application:

Recommended for valves mounted at lower levels in wells or directly in the ground.

Connection with the valve:

axial – extension spindle

not axial - extension spindle with cardans

Accessories:

Rigid extension spindle see: 9006; 9010

Telescopic extension spindle see: 9007; 9011

Extension spindle see: 9008

Rigid extension spindle with cardan see: 9116

Handwheel see: 9301

Locking device

Execution variant:

With inductive or electromechanical sensors

Other executions on request

Installation:

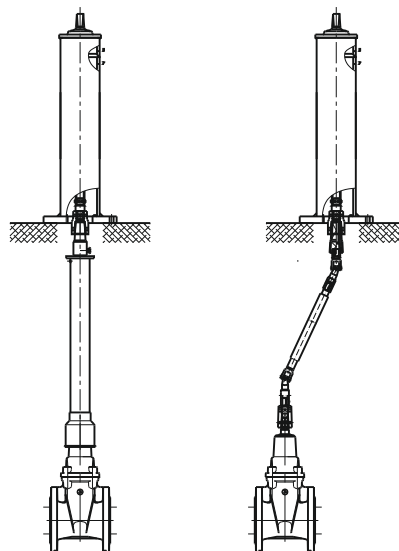

We reserve the rights to modify the production program and the given data without separate notices due to the permanent company development